



## Features

- Super compact case -fits into any J-box
- Constant Voltage Mode
- Universal AC input / Full range: AC120V
- Strong Compatibility, flicker-free dimming
- ETL certification, Class II power unit
- Protections: Short circuit/ Overload/ Over Voltage
- Suitable for dry or damp location,
- Suitable for LED strip, LED tape, Linear Lights or LED Pack Lights etc.

**12/24  
VOLT**

**CLASS  
2**

## Constant Voltage Super Compact dimmable driver

### ■ Dimming Operation

※ Triac Dimmable

### ■ Mechanical Diagrams

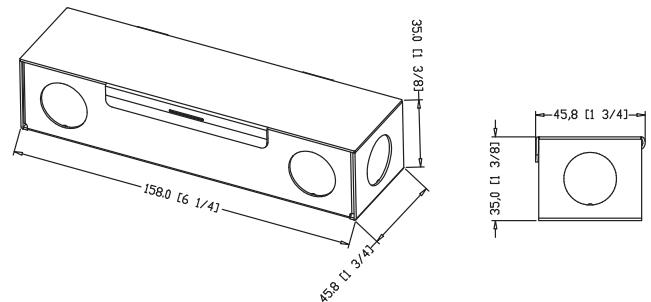
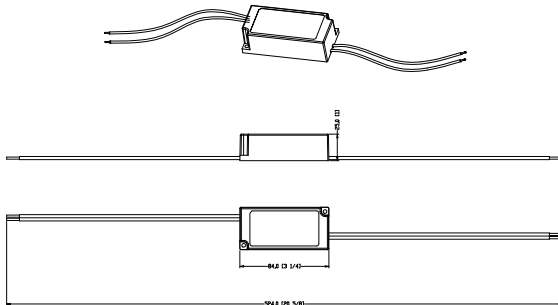

### ■ Connecting Diagram

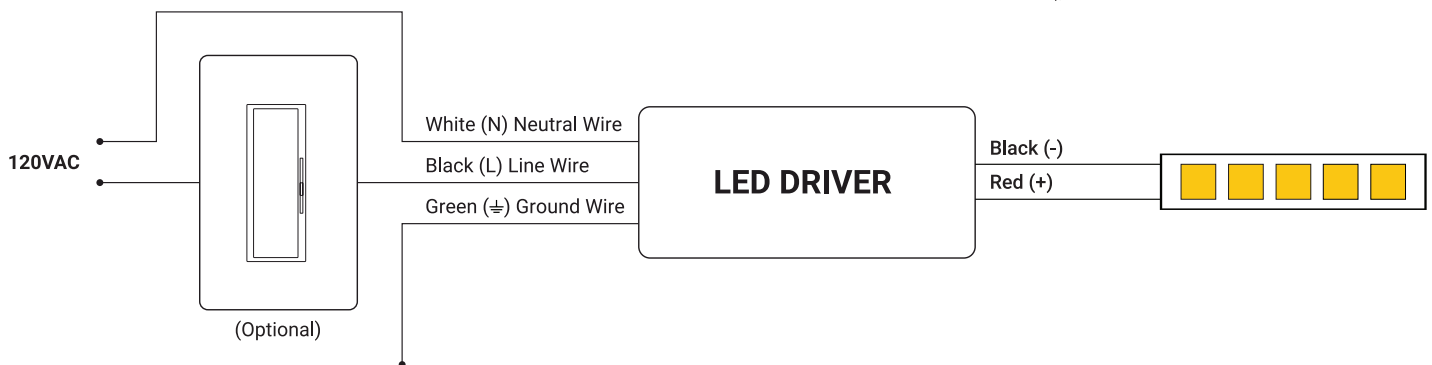

SPECIFICATIONS		
Model	HBL096-AW-24-10DAP	
Wattage	96W	
Input Output	120VAC 50/60Hz	
Power Factor	0.93	
Efficiency(Typ)	88%	
THD(Max)	25%	
Output Voltage	24VDC	
Rated Current	4A	
Certificates	ETL	
Protection	Short Current	Hiccup mode, recover automatically after fault condition is removed
	Over Loading	≤120%
Environment	Working TEMP.	-25°C to 45°C
	Working Humidity	20~90%RH, non-condensing
	Storage TEMP. Humidity	-40~+60°C, 10~95%RH
Safety&EMC	Safety standards	UL8750
	Withstand voltage	I/P-O/P:1500VAC
	Isolation resistance	I/P-O/P:100M Ω /500VDC/25°C/70%RH
Notes	1. All parameters if NOT specially mentioned are measured at 120VAC input , rated load and 25°C of ambient temperature. 2. To extend the driver's using life, please reduce the loading at lower input voltage 3. Loading should be 5-100%	

## INSTRUCTIONS:

- 1) This driver should be installed by a qualified professional
- 2) Please make sure the transformer is installed with adequate ventilation around it to allow for heat dissipation.
- 3) Ensure that wiring is correct before testing in order to avoid light and power supply damage.

Dimmer Compatible Chart

Brand	Series	Model	Load	Dimmability
Lutron	Ariadni	AYCL-153P	150W	10%-100%
	Diva	DV-600PR	600W	1%-100%
	Diva	DVCL-153P	150W	10%-100%
	Maestro	MACL-153MH	600W	10%-100%
	Maestro Wireless	MRF2-6CL	150W	10%-100%
	Rotary	D-600P	600W	10%-100%
	Electronic(ELV)	NTELV-300P	600W	10%-100%
	Skylark	S-600P	600W	10%-100%
	Skylark Conytour	CT-600P	600W	1%-100%
	Skylark Conytour	CTCL-153P	150W	10%-100%
	Toggler	TG-600P	600W	10%-100%
	Toggler	TCCL-153P	150W	10%-100%
Leviton	Sureslide	6633	600W	10%-100%
	Sureslide Decora	6674	600W	20%-100%
	Trimatron	6602	600W	20%-100%
	ILLVMATECH	IPL06	600W	1%-100%
Legrand	Adorne	ADTP703TU	700W	20%-100%
	Harmony	H703PTW	700W	10%-100%
Cooper	Aspire	9540	1000W	10%-100%
	Devine	DAL06P	300W	10%-100%

Adision has provided this dimmer switch compatibility chart for guidance when selecting a dimmer and lamp combination. Our lamps were tested for compatibility with the above listed dimmer. Dimmers that do not appear on the chart might still be compable but have not been tested. All testing has been performed with a stable main supply. The quality od the local main. existing installation and wiring. as well as different manufacturer versions of the above diommers may affect dimming performance. Since no assurance can be provided regarding these factor. it is s general recommendation to perform a test on-site prior to installing the LED lamp.